

Colour Legend

- Retroreflective white
- Retroreflective blue
- Retroreflective red
- Retroreflective yellow



**Queensland
Government**

TRAFFIC INSTRUCTION SIGN

"ROAD CLOSED AHEAD/
FOLLOW DIVERSION ROUTE"

Department of Transport and Main Roads
Infrastructure Management & Delivery Division

APPROVED AS OFFICIAL TRAFFIC SIGN

Designed
RH 06/20

Checked
DJ 06/20

Scale
Not to Scale

[Signature]
PRINCIPAL ENGINEER
(Traffic Engineering)

15/06/20
Date

TC2327_1

Page 1/2

A

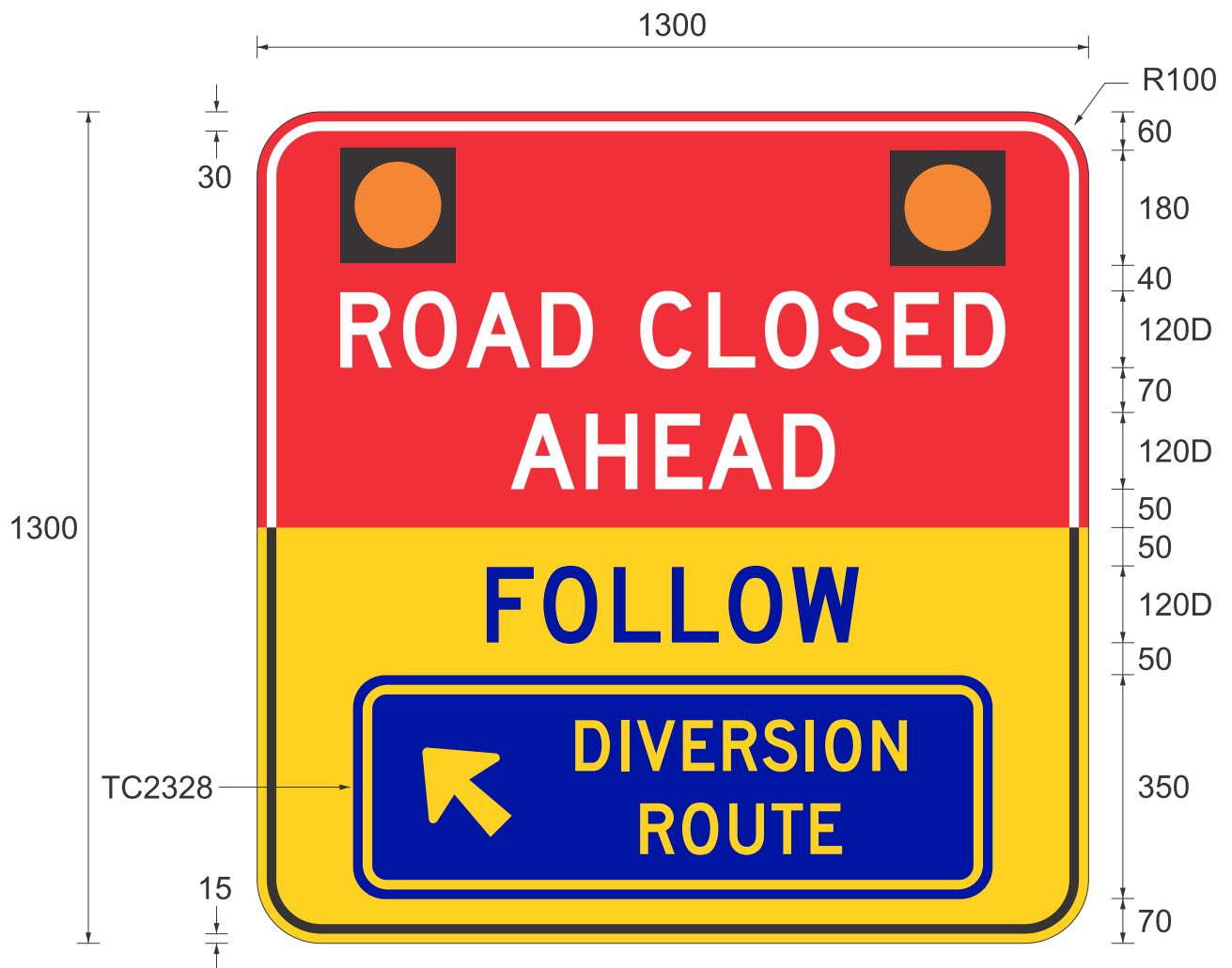

Colour Legend

- Retroreflective white
- Retroreflective blue
- Retroreflective red
- Retroreflective yellow



**Queensland
Government**

TRAFFIC INSTRUCTION SIGN

"ROAD CLOSED AHEAD/FOLLOW DIVERSION ROUTE" WITH FLASHING LIGHTS

Department of Transport and Main Roads
Infrastructure Management & Delivery Division

APPROVED AS OFFICIAL TRAFFIC SIGN

Designed
RH 06/20

Checked
DJ 06/20

Scale
Not to Scale

[Signature]
PRINCIPAL ENGINEER
(Traffic Engineering)

15/06/20
Date

TC2327_2

Page 2/2

A